

BOROUGH OF WOODSTOWN

SHEET 14

SHEET 14

SHEET 22

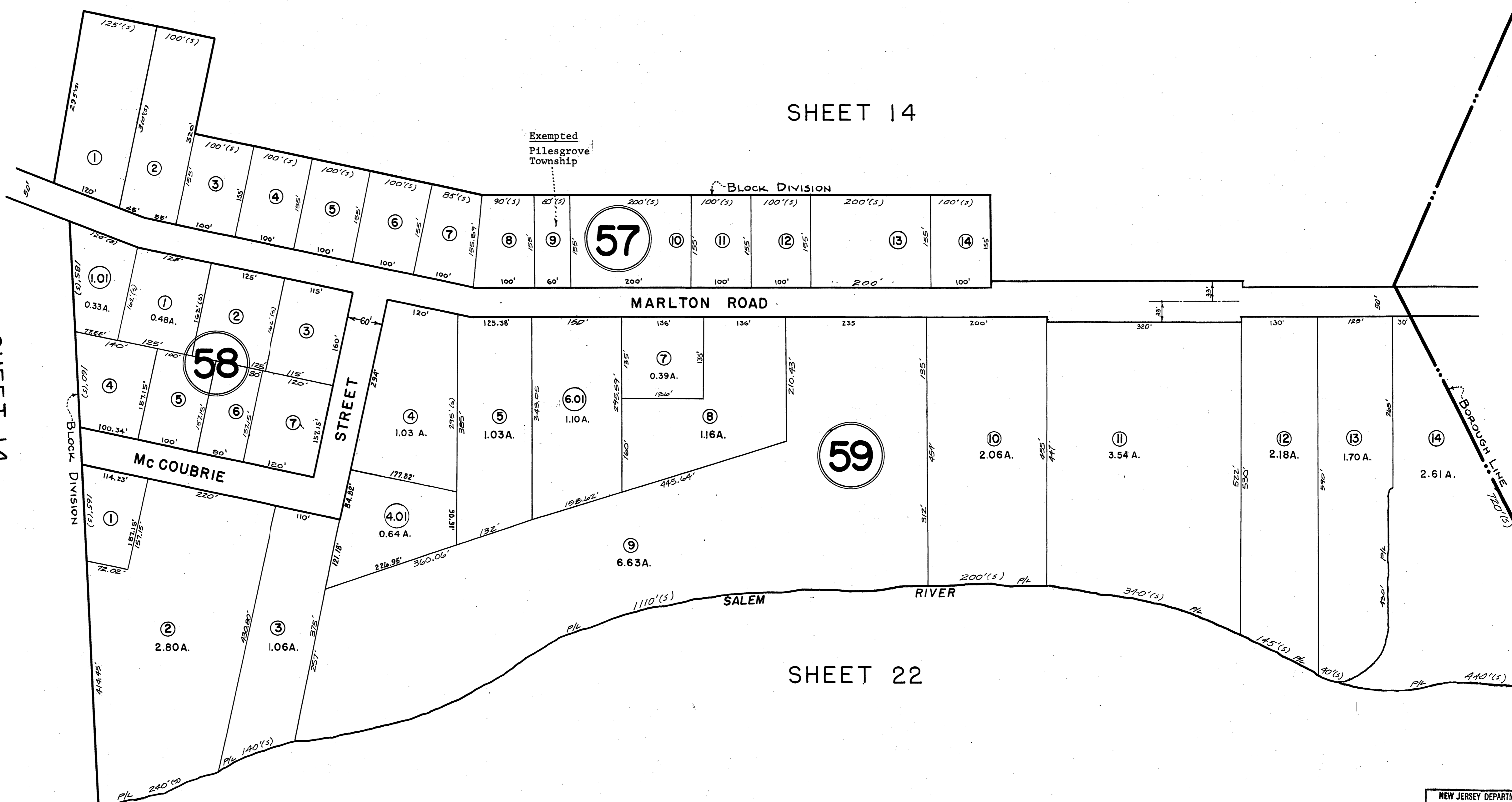

Block 59, Lot 6 unassigned combined w/ Lot 6.01 - 11/28/01

NEW JERSEY DEPARTMENT OF THE TREASURY
 DIVISION OF TAXATION
 ENGINEERING & RAILROAD TAX BUREAU
 APPROVED AS A TAX MAP PURSUANT TO THE
 PROVISIONS OF CHAPTER 175, LAWS OF 1913, ETC.
 FOR THE DIRECTOR, DIVISION OF TAXATION
 BY *C. P. Barnes* STATE SUPERVISOR
 DATE AUG - 8 1961 SERIAL NO. 327

TAX MAP
PILESGROVE TOWNSHIP
 SCALE 1" = 100' SALEM CO., N.J.
 SKINNER & COMPTON, ENGINEERS
 JULY 3, 1961

THIS SHEET IS A SCANNED COPY OF THE TAX MAP ORIGINALLY PREPARED BY EUGENE
 COMPTON OF SKINNER & COMPTON, ENGINEERS, DATED: JULY 3, 1961.
 THE ORIGINAL APPROVED MAP IS ON FILE IN THE OFFICE OF THE TOWNSHIP ENGINEER.